

*Thank you for purchasing this Autel tool. This tool is manufactured to a high standard and will provide years of trouble-free performance when used in accordance with these instructions and properly maintained.*

**! IMPORTANT:** Before operating or maintaining this unit, please read these instructions carefully. Use this unit correctly and with care as failure to do so may cause damage and/or personal injury and will void the product warranty.

### Move out the Calibration Frame

1

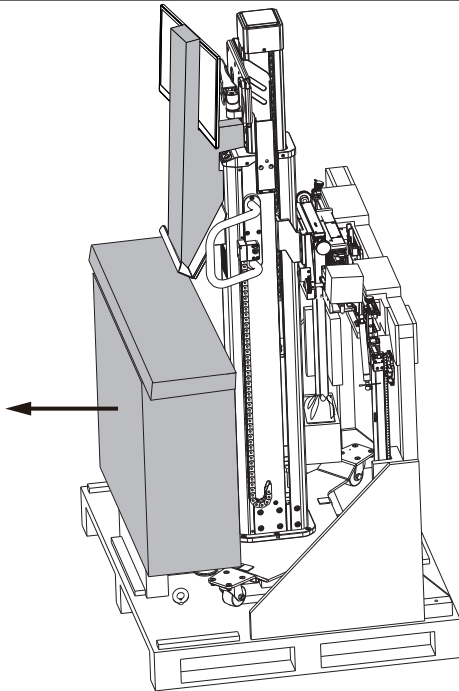

Remove the dust cover. Cut the packing bands that fasten the package boxes. Remove all boxes and foam paddings from the frame.

2

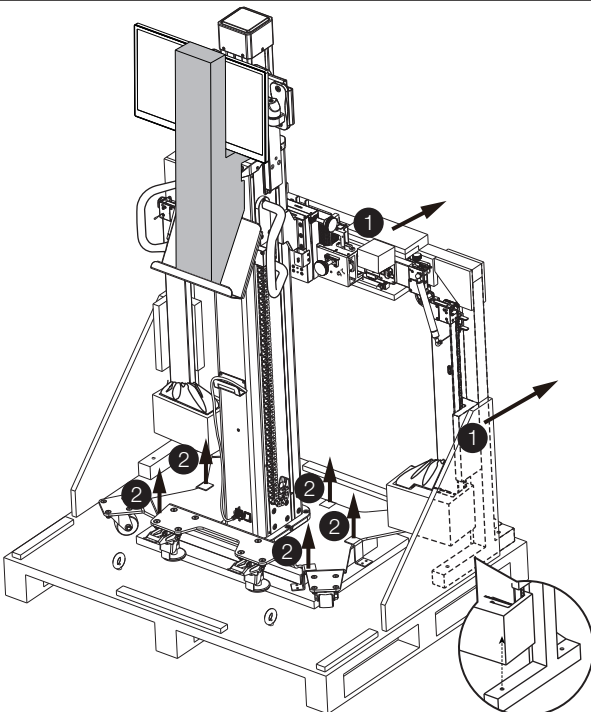

Unscrew the four screws on the bottom of the wooden shipping bar with an open-end wrench (14 mm) to remove the stand bar (1). Be careful not to scratch the calibration frame. Remove all z-shaped metal corner brackets (2).

3

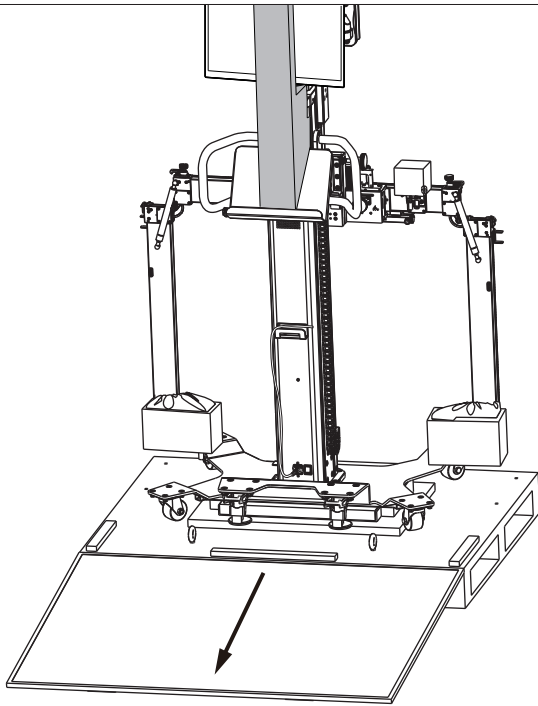

Attach the plywood cover to the skid at the rear side of the calibration frame to serve as a ramp. Remove the protective film from the footbrakes and ensure the footbrakes are released. Lift the calibration frame slightly to remove it from the skid and carefully roll the calibration frame down the ramp to your workspace floor. Depress the footbrakes when the calibration frame is well placed.

## Uncover the Touchscreen Monitor

1

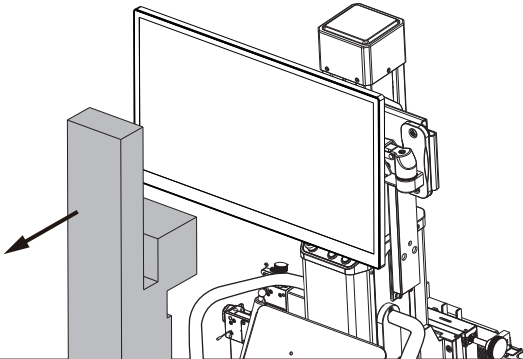

Remove the protective film and foam padding around the touchscreen monitor. Adjust the monitor to an appropriate position for viewing.



**NOTE:** After removing the foam padding, check whether the Emergency Stop button is pressed down inadvertently. If so, rotate the button clockwise to release it.

2

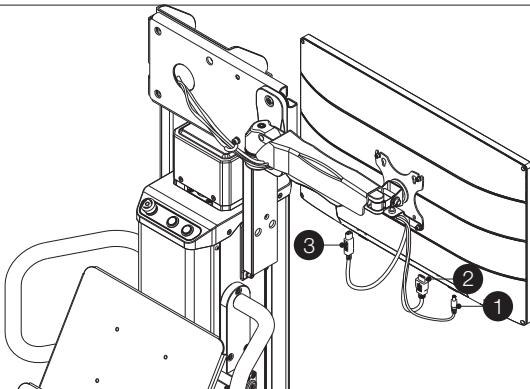

Remove the protective film from the cables. Plug the power cable, HDMI cable, and USB cable into their respective input ports on the touchscreen monitor.

Power Cable (1)

HDMI Cable (2)

USB Cable (3)

## Unfold the Crossbar

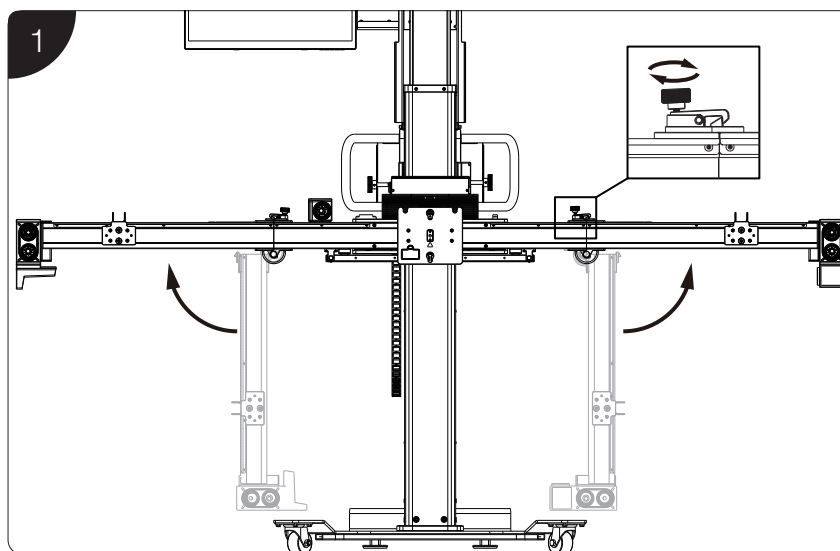

Remove the foam padding and protective covers from the three camera units. Manually raise both arms of the crossbar until they are parallel and make sure the folding arm latches are locked. Tighten the crossbar fastening knobs to secure the crossbar.

## Power up the IA900WA

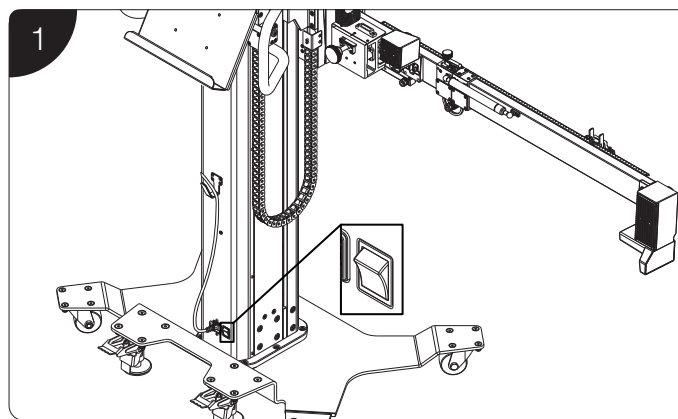

Once the calibration frame is in the proper location, plug the power cord at the bottom of the column into a power socket, and then turn on the power switch. When the power is on, the power switch will illuminate red, all the cameras will flash red in a circle, and the monitor will light up, displaying the procedure for connecting a tablet to the calibration frame.



**NOTE:** To prevent the cord from becoming tangled accidentally, please secure the excess cord with a cable tie.



**NOTE:** System power requirements: 100–264 volts AC, <5 amps, and 50–60 Hz (must be grounded).

## Assemble the Pattern Board

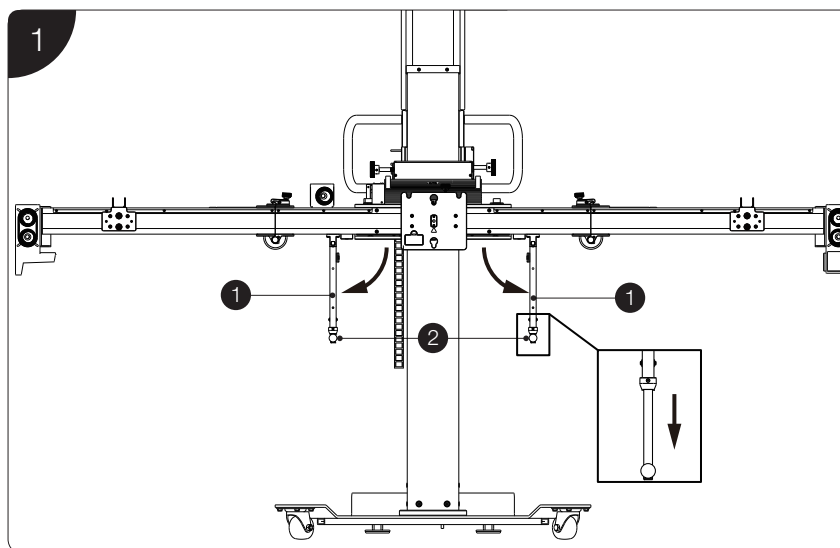

Unfold and straighten the left and right pattern board holders (1) from the crossbar. Pull the ends (2) down to extend the pattern board holders.

2

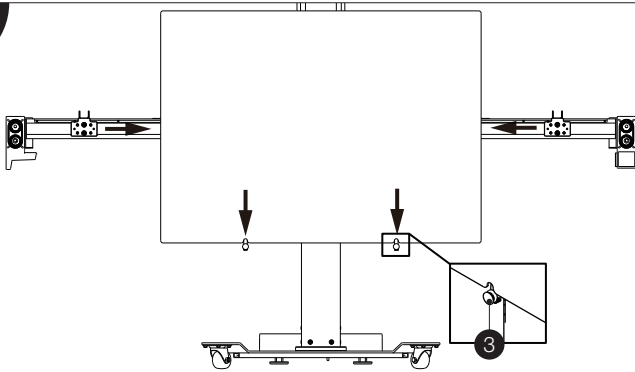

Align the grooves on the lower edge of the pattern board with the positioning spaces (3) on the pattern board holder ledges. Press the clamps on the left and right sliding plates, then move the sliding plates towards the pattern board to secure the pattern board in the slots on the sliding plates.

3

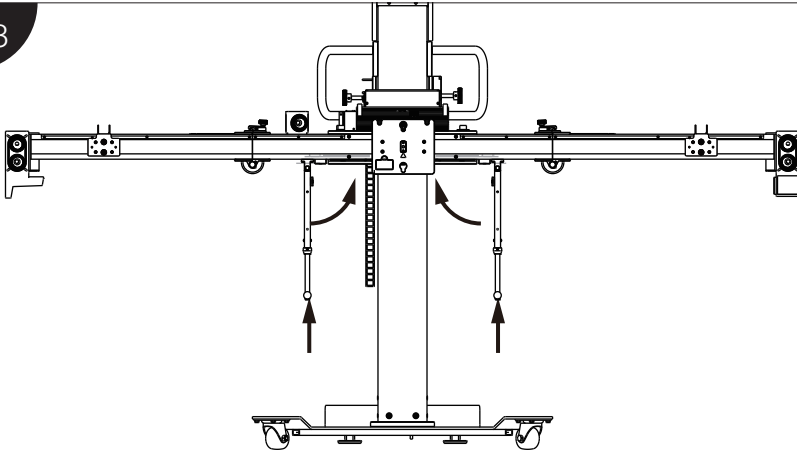

Remove the pattern boards after calibration. Slide the pattern board holders upward. Fold the left and right pattern board holders until they lock into the crossbar.

## Fold the Crossbar for Storage

1

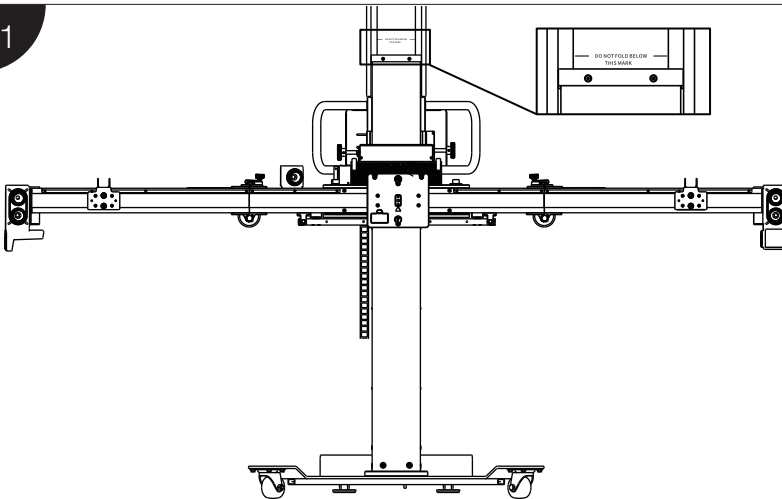

**NOTE:** To prevent the cameras from striking the ground and getting damaged, fold the crossbar when the warning in the inner red column is visible.

2

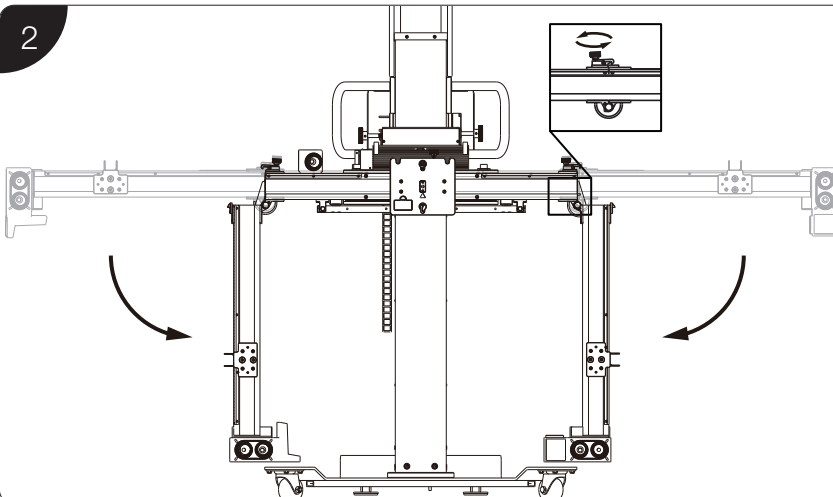

Fully loosen the crossbar fastening knobs. Support the arms while pressing the knobs to unlock them. Gently fold each arm downward for storage.

**NOTE:** The illustrations in this Quick Reference Guide are for reference only. The actual product may differ.